

**THERMACUT® REPLACEMENT PARTS SUITABLE FOR  
ESAB®/L-TEC®  
PT-23™**

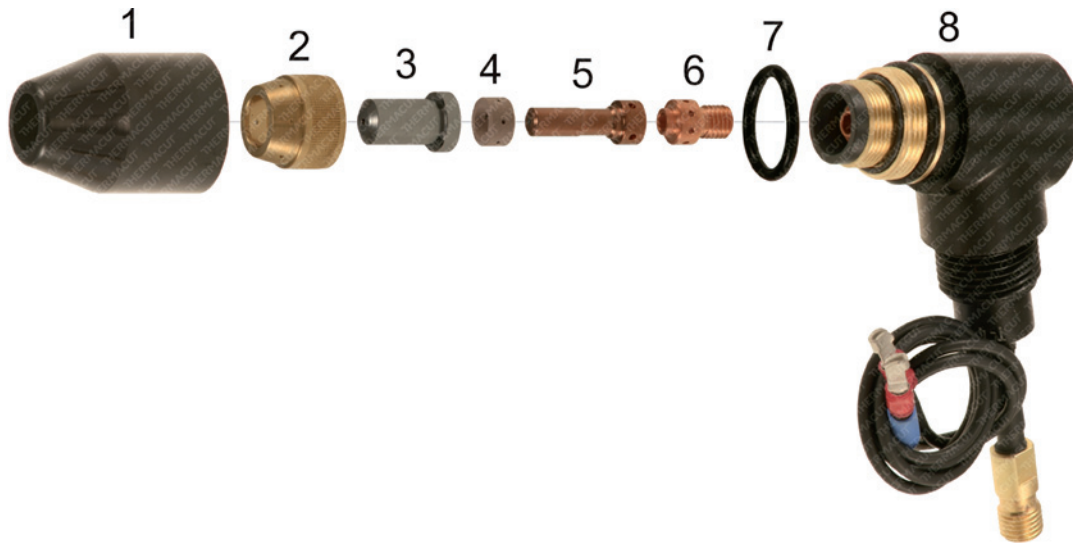

| Item | Part No. | Ref. No. | Description   | Std. Pkg. | Item | Part No. | Ref. No. | Description      | Std. Pkg. |
|------|----------|----------|---------------|-----------|------|----------|----------|------------------|-----------|
| 1.   | T-1258   | 33419    | Shield        | 1         | 5.   | T-1264   | 33366    | Electrode        | 10        |
| 2.   | T-1259   | 33371    | Retaining Nut | 1         | 6.   | T-2016   | 33417    | Replaceable Seat | 1         |
| 3.   | T-1260   | 33368    | Nozzle 30A    | 10        | 7.   | T-1306   | 85W51    | O-Ring           | 1         |
|      | T-1261   | 33369    | Nozzle 50A    | 10        | 8.   | T-1265   | 21421    | Torch Head       | 1         |
|      | T-1262   | 33418    | Nozzle 80A    | 10        | NS   | T-1986   | 21420    | Stand-off Guide  | 1         |
| 4.   | T-1263   | 33367    | Swirl Baffle  | 5         |      |          |          |                  |           |

NS NOT SHOWN IN THE PICTURE

**Last update of this page: 17/11/2015. See Revision history for details.**

**THERMACUT®**  
THE CUTTING COMPANY

WWW.THERMACUT.CZ  
TEL.: +420 556 423 418  
SALES@THERMACUT.CZ

WWW.THERMACUT.DE  
TEL.: +49 (0) 27 39 40 33 0  
INFO@THERMACUT.DE

WWW.THERMACUT.COM  
TEL.: 1-603-542-6715  
CUSTOMERSERVICE@THERMACUT.COM

THERMACUT®, THE CUTTING COMPANY®, FHT-EX®, EX-TRAFIRE®, EX-TRACK®, EX-TRABEAM® AND EX-TRAFAME® ARE REGISTERED TRADEMARKS OF THERMACUT, K.S. AND MAY BE REGISTERED IN CZECH REPUBLIC AND/OR OTHER COUNTRIES. ALL OTHER TRADEMARKS ARE PROPERTIES OF THEIR RESPECTIVE OWNERS. THERMACUT IS NO WAY AFFILIATED WITH ESAB®/L-TEC®. MOST THERMACUT PARTS ARE MADE FOR OR BY AN IBC COMPANY. PARTS INDICATED WITH A OEM ARE ORIGINAL PARTS MANUFACTURED BY THE ABOVE NAMED MANUFACTURER AND ARE BEING RESOLD BY THERMACUT. THERMACUT RESERVES THE RIGHT TO SUBSTITUTE OEM PARTS IN PLACE OF THERMACUT PARTS. VALID FROM NOVEMBER 2020 • PREVIOUS VERSION IS NO LONGER VALID. • © COPYRIGHT 2020 BY THERMACUT® CZECH REPUBLIC. ALL RIGHTS RESERVED.